



Outer Molding/Inner Molding Replacement

CAUTION: Wear gloves to remove and install the inner molding and outer molding.

NOTE:

- Take care not to twist or scratch the moldings.
- The numbers after the part names show the quantities of the parts used.

Outer Molding:

OUTER MOLDING

- Remove the glass (see page 20-7)
- Remove the sash cover.
- Pry the clips out using a flat tip screwdriver, then pull up the outer molding.

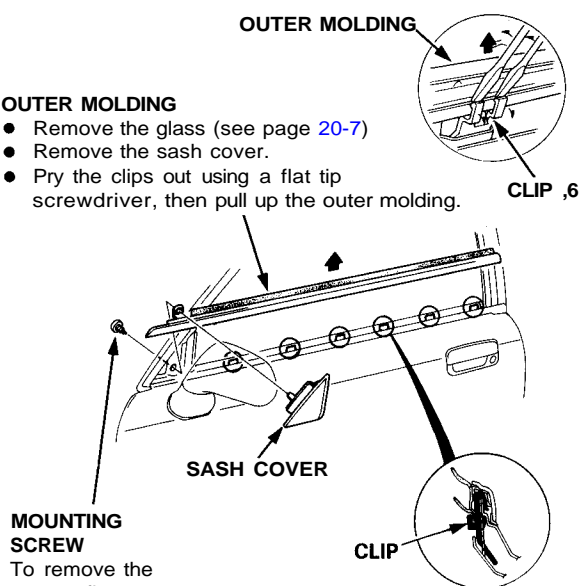

MOUNTING SCREW

To remove the screw, first remove the front inner trim (see page 20-10).

Inner Molding:

INNER MOLDING

- Remove the door panel (see page 20-4).
- Pry the clips out using a flat tip screwdriver, then pull up the inner molding.

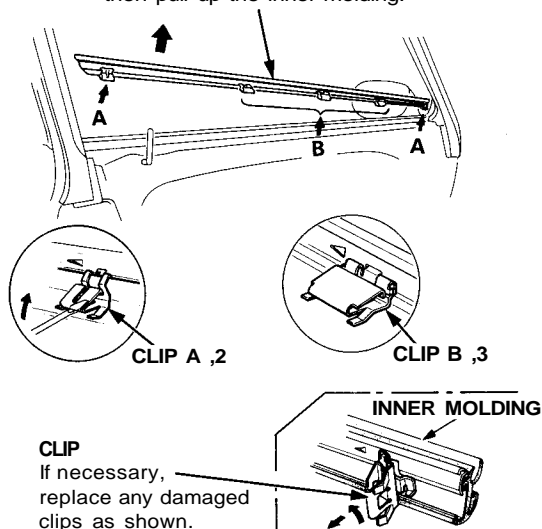

CLIP
If necessary, replace any damaged clips as shown.

Installation is the reverse of the removal procedure.

Sash Trim Replacement

NOTE:

- Lower the glass fully.
- Take care not to scratch the sash trim.

SASH TRIM

Peel the outer weatherstrip (see page 20-10) out, then remove the screws and clip. Remove the sash trim.

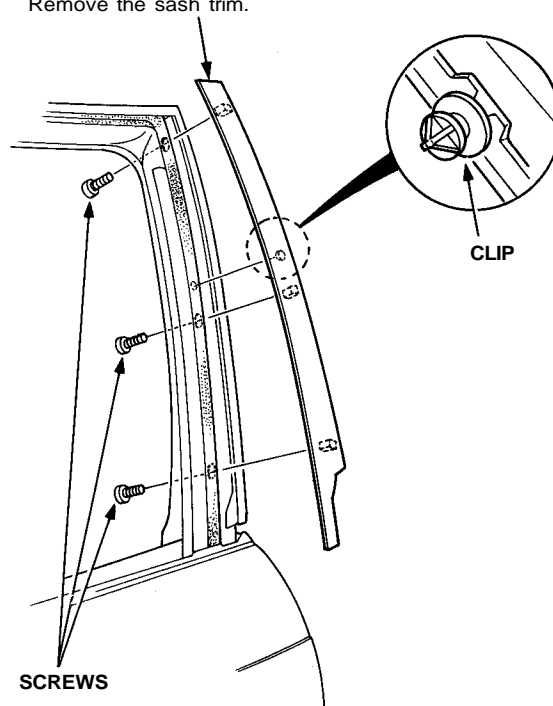

Installation is the reverse of the removal procedure.